

NOTE:

VERIFY W/ ENGINEER IF DOUBLE SILL PLATE
W/ TWO ROWS OF 1 1/2" SCREWS OR 2"-8d
NAILS @ 4" O.C. STAGGERED ON EACH
SIDE IS AN ACCEPTABLE ALTERNATE

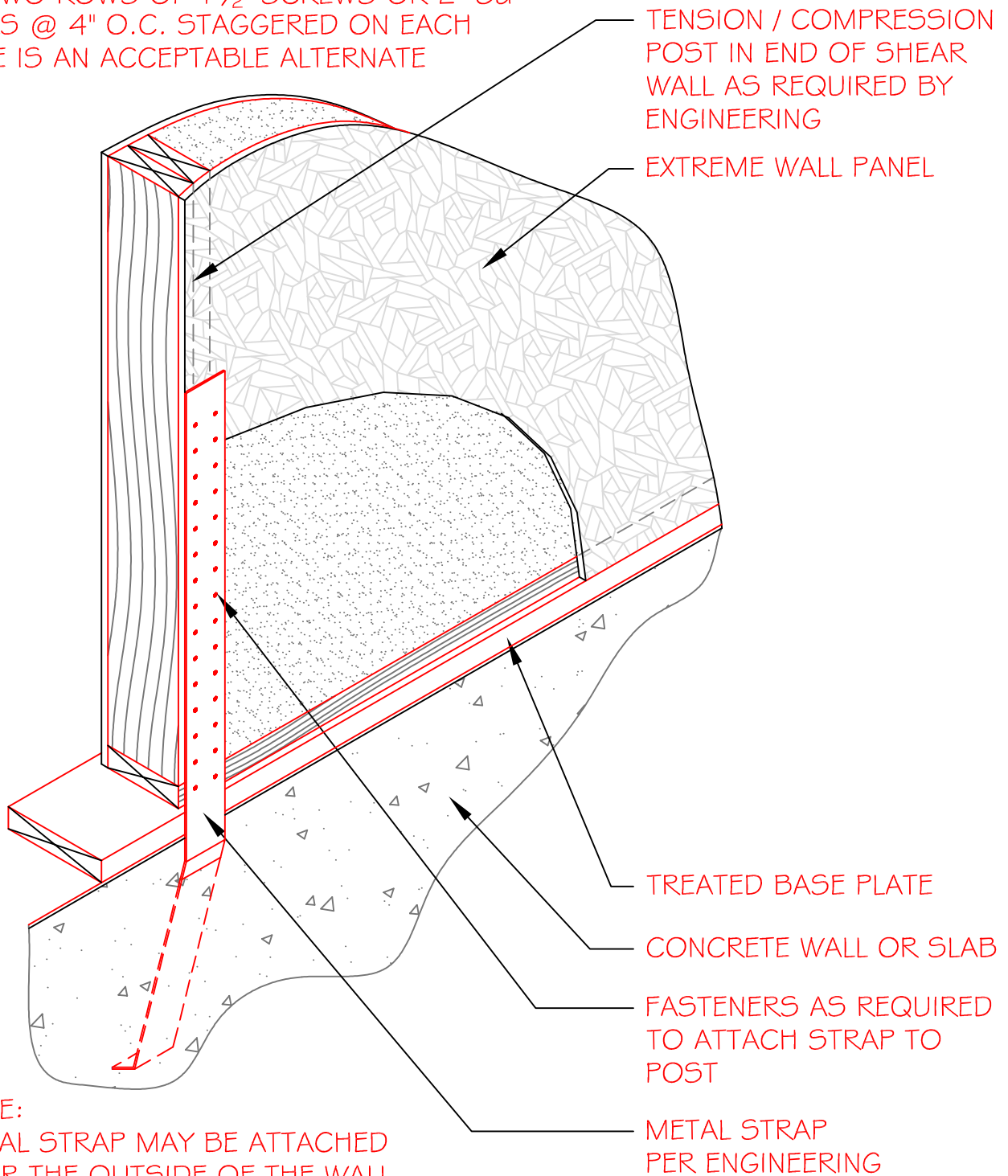

NOTE:

METAL STRAP MAY BE ATTACHED
OVER THE OUTSIDE OF THE WALL
PANEL - USE FASTENERS THAT WILL
NOT AFFECT FINISHING OF THE WALL

SECTION
NOT TO SCALE

DETAIL TITLE : STRAP HOLDDOWN CONNECTION

DETAIL NO. : EP-212

PAGE NO. : 2 - 12

UPDATED : MARCH 2017

Extreme Panel

TECHNOLOGIES, INC.

STRUCTURAL INSULATED PANELS