

EXTREME ROOF PANEL

L-SHAPED WEDGE FASTENED TOGETHER W/ PANEL SEALANT & 3" CONST. LAGS 24" O.C. OR 16d NAILS @ 12" O.C. IN FIELD, THEN FILL VOID W/ 2-PART EXPANDABLE FOAM OR EPS RIGID FOAM (BASE PLATE IS TREATED AND FASTENED TO ICF W/ ANCHOR BOLTS)

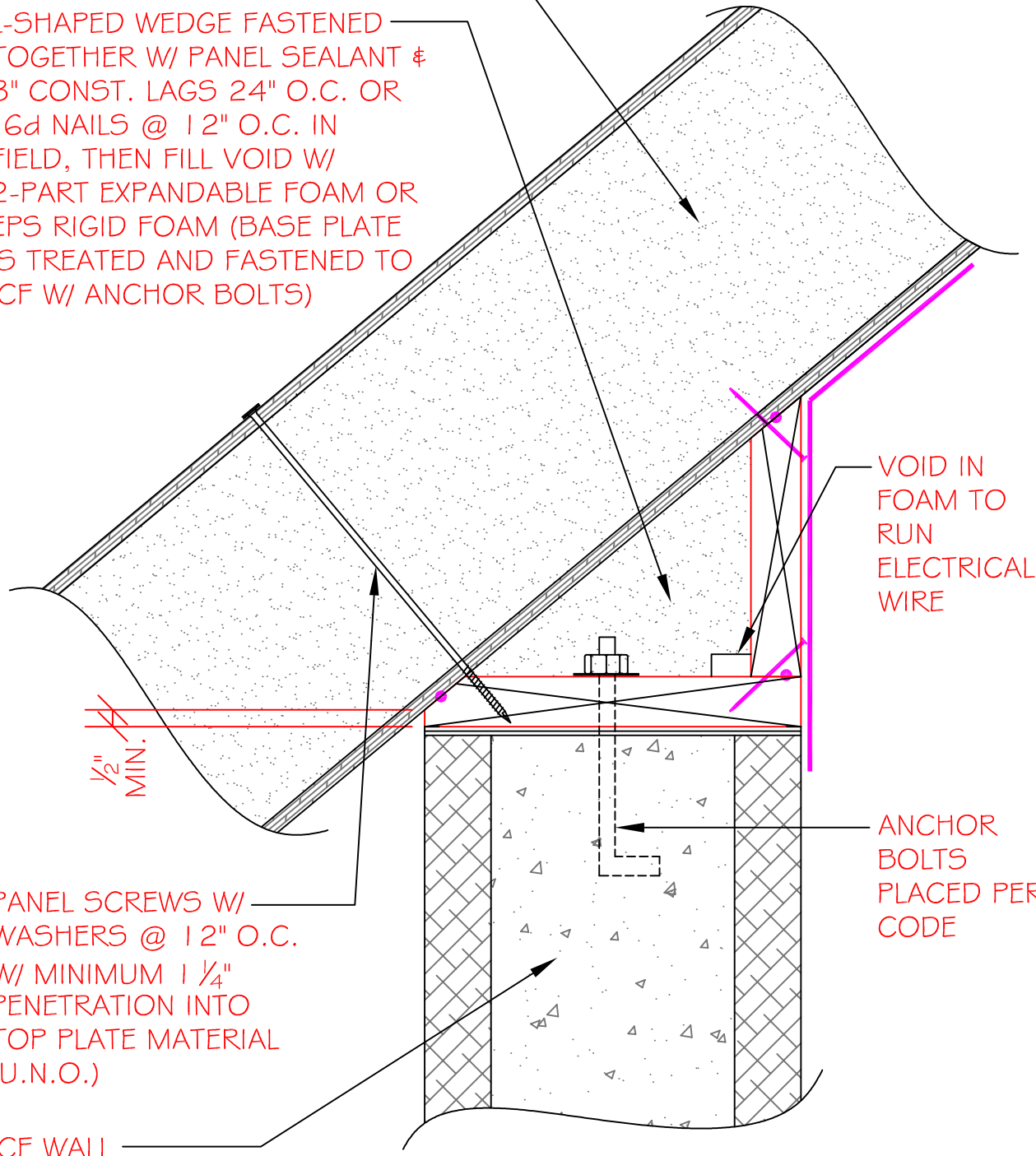

VOID IN FOAM TO RUN ELECTRICAL WIRE

1/2" MIN.

ANCHOR BOLTS PLACED PER CODE

PANEL SCREWS W/ WASHERS @ 12" O.C. W/ MINIMUM 1 1/4" PENETRATION INTO TOP PLATE MATERIAL (U.N.O.)

ICF WALL

SECTION
NOT TO SCALE

DETAIL TITLE : ROOF TO ICF CONNECTION

DETAIL NO. : EP-404

PAGE NO. : 4 - 4

UPDATED : MARCH 2017

Extreme Panel

TECHNOLOGIES, INC.

STRUCTURAL INSULATED PANELS