

1. RECOMMENDED BRACING SHOULD BE PLACED EVERY 12'-0".
2. RECOMMENDED BRACE THICKNESS:
 - * 8'-0" TO 10'-0" PANEL - 2x4
 - * 12'-0" TO 16'-0" PANEL - 2x6
3. KEEP THE TOP 2x4x12" BLOCK WITHIN 2'-0" FROM THE TOP OF THE PANEL.
4. RECOMMENDED BRACE LENGTH SHOULD BE $\frac{2}{3}$ THE HEIGHT OF THE PANEL.
5. THE BRACING INSIDE AND OUTSIDE SHOULD BE LEFT ASSEMBLED UNTIL THE ROOF IS IN PLACE AND PROPERLY FASTENED.

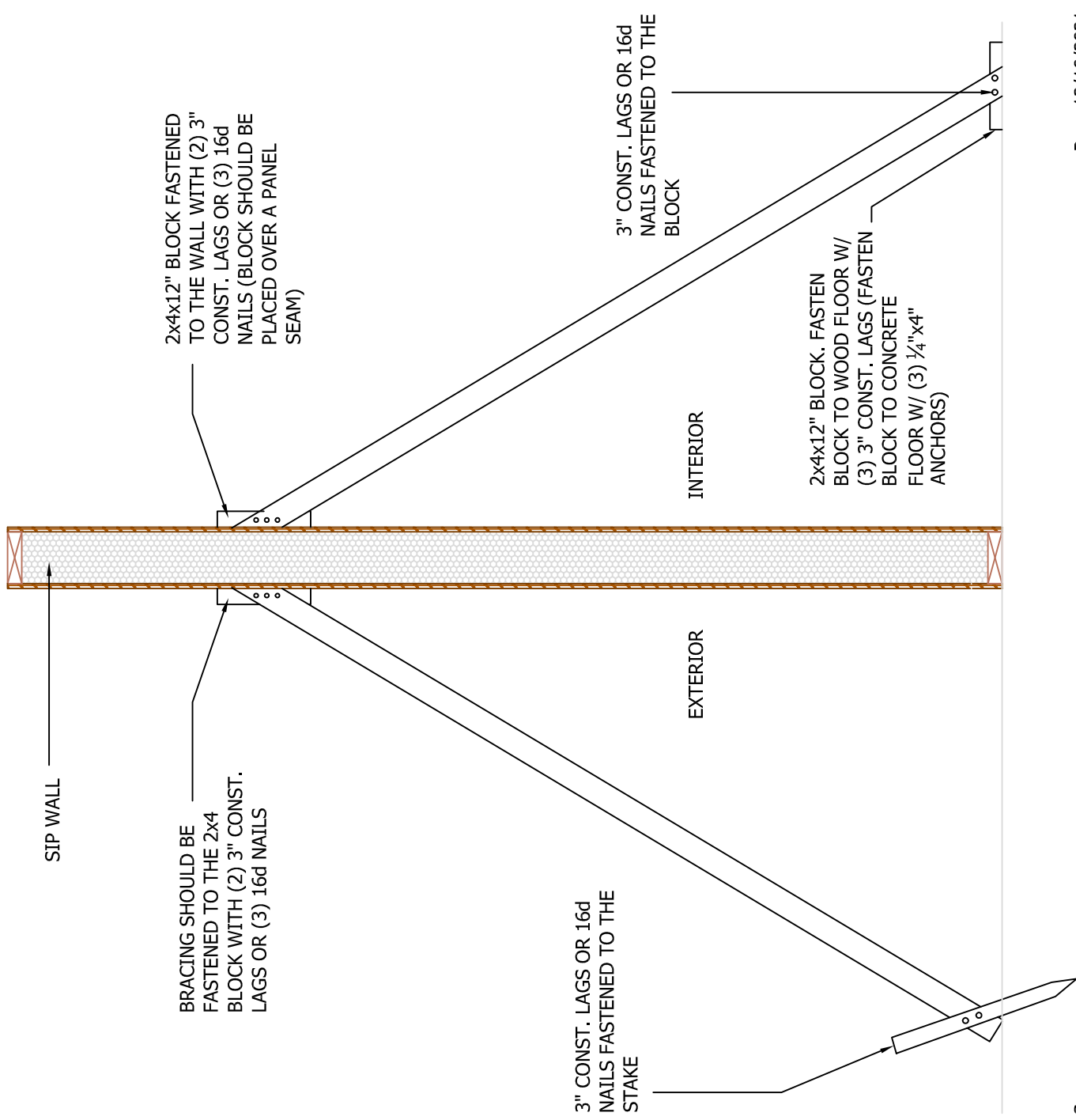

N.T.S.

Rev: 12/10/2021