

NOTES:

1. FACINGS ARE THE LOAD BEARING COMPONENT IN A SIP. WIDTH OF ANY LUMBER INSTALLED TO TOP OF SIP WALL MUST BE FULL WIDTH OF SIP IN ORDER TO TRANSFER LOADS TO FACINGS.
2. CAP PLATE MAY BE USED TO INCREASE POINT LOAD CAPACITY AND/OR INCREASE WALL HEIGHT.
3. NON-STRUCTURAL SPACER MAY BE USED TO INCREASE WALL HEIGHT ONLY.

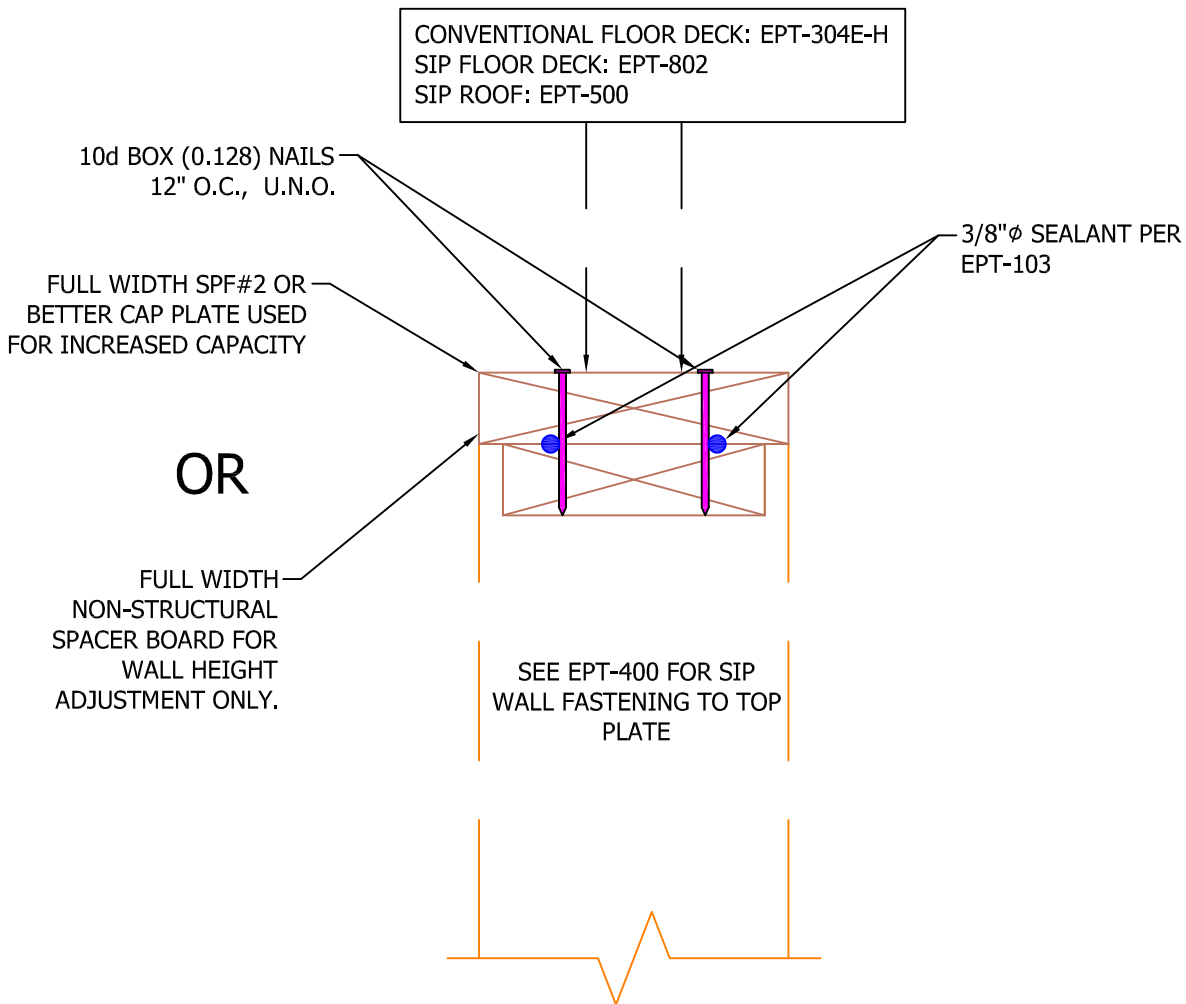

N.T.S.

Rev: 7/21/2022

EPT -405

CAP PLATE CONNECTION