

NOTE:

FACINGS ARE THE LOAD BEARING COMPONENT IN A SIP. WIDTH OF ANY LUMBER INSTALLED TO BOTTOM OF SIP WALL MUST BE FULL WIDTH OF SIP IN ORDER TO TRANSFER LOADS TO BEARING BELOW.

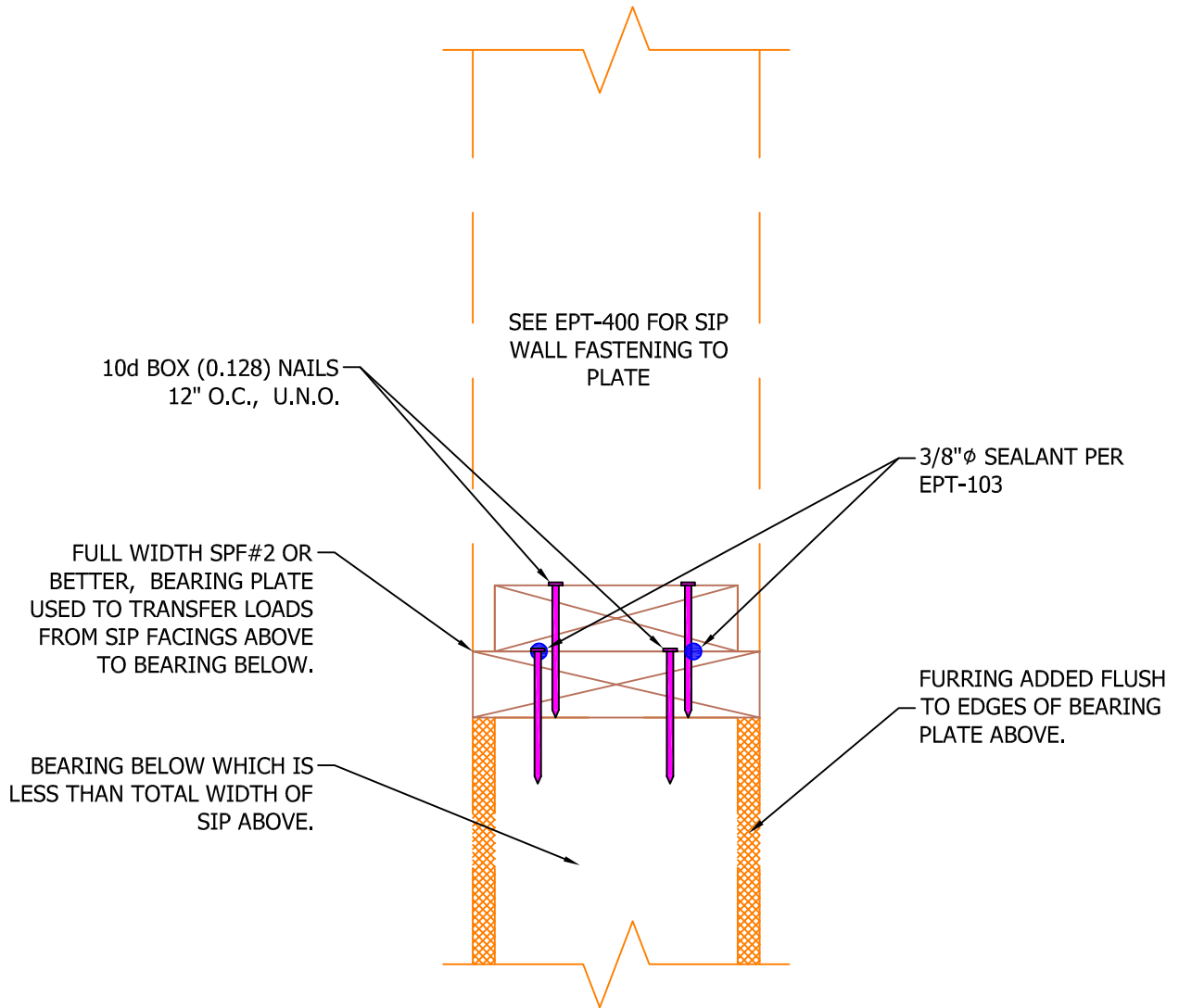

N.T.S.

Rev: 7/21/2022

EPT -406

BEARING PLATE

