

NOTE:
SEE EPT-600 FOR ALTERNATE SIP BEARING CONDITIONS

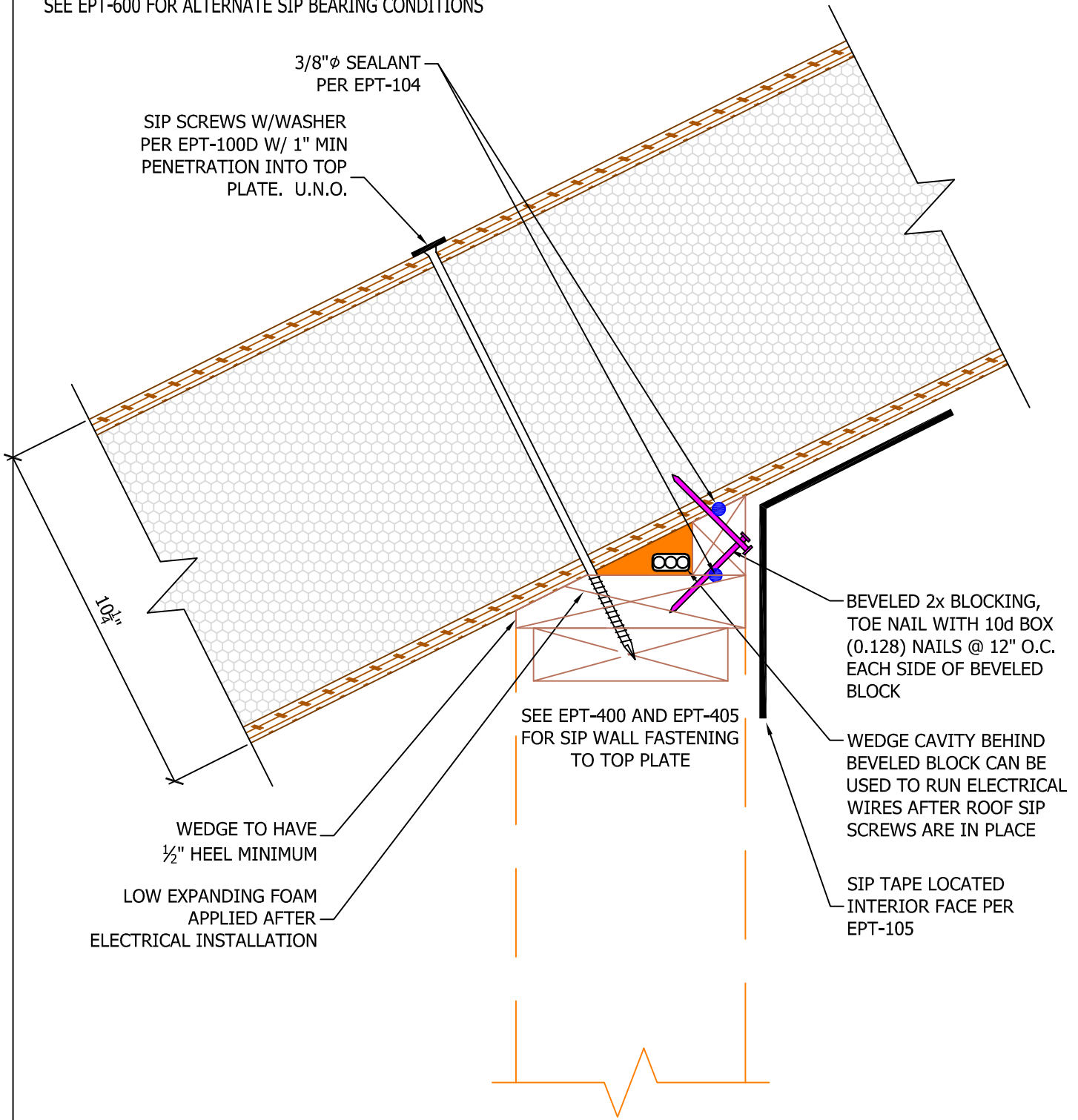

3/8" ϕ SEALANT
PER EPT-104

SIP SCREWS W/WASHER
PER EPT-100D W/ 1" MIN
PENETRATION INTO TOP
PLATE. U.N.O.

10 1/2"

WEDGE TO HAVE
1/2" HEEL MINIMUM

LOW EXPANDING FOAM
APPLIED AFTER
ELECTRICAL INSTALLATION

SEE EPT-400 AND EPT-405
FOR SIP WALL FASTENING
TO TOP PLATE

BEVELED 2x BLOCKING,
TOE NAIL WITH 10d BOX
(0.128) NAILS @ 12" O.C.
EACH SIDE OF BEVELED
BLOCK

WEDGE CAVITY BEHIND
BEVELED BLOCK CAN BE
USED TO RUN ELECTRICAL
WIRES AFTER ROOF SIP
SCREWS ARE IN PLACE

SIP TAPE LOCATED
INTERIOR FACE PER
EPT-105

N.T.S.

Rev: 9/19/2022

EPT -500

**SIP WALL TO ROOF
BEVELED BLOCK**

